

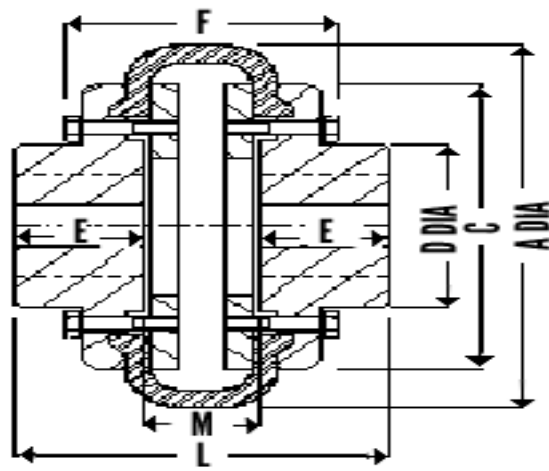

**UNIQUE Tyre Type Automatic Flexible Cushion Couplings – TC Series**

**GENERAL ASSEMBLY DRAWING**



**UPTO SIZE TC/M/017**

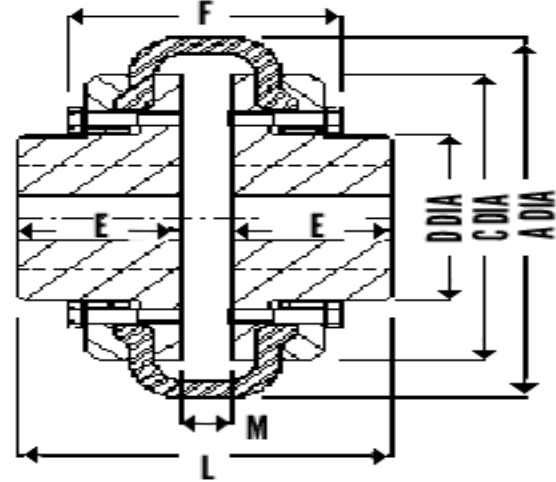

**SIZE TC/L/018 AND LARGER**

**DIMENSIONS AND TECHNICAL DATA**

SIZE	Max Bore mm	Max Speed RPM	Cont. Rating Torque Nm	HP/100 Rpm	Max Torque Nm	A Dia mm	Appx Dimensions L inch	D Dia mm	E Nm	M mm	Torsional Stiffness NM/rad	Inertia MR <sup>2</sup> KgM <sup>2</sup>	Max Misalignment Radial mm	Axial mm	Ang deg	Weight Kg
TC/Z/001	9	6000	Nominal			42	54	27	19	16	60	-	0.1	0.2	3	0.2
TC/Z/002	11	6000	Nominal			54	68	38	24	20	150	0.0001	0.1	0.2	3	0.5
TC/Z/003	14	6000	Nominal			70	78	43	27	24	220	0.0003	0.1	0.2	3	0.7
TC/Z/004	18	6000	Nominal			93	74	30	26	22	415	0.0006	1.5	0.2	3.5	0.9
TC/Y/005	22	5500	6	0.08	18	97	74	35	25	24	520	0.0008	1.5	0.2	4	1.3
TC/X/006	24	5500	12	0.17	36	105	84	38	32	20	630	00.001	1.5	2.5	4	1.6
TC/W/007	28	5500	18	0.25	54	105	111	43	40	31	1000	00.001	1.5	2.5	4	1.7
TC/V/008	32	5500	24	0.34	72	120	95	51	37	21	1455	00.003	1.5	2.5	4	2.7
TC/U/009	38	5500	36	00.5	108	135	108	58	39	30	1890	00.005	0.2	2.5	4	3.4
TC/US/0095	42	5500	46	0.65	138	144	120	66	48	24	2400	00.008	0.2	2.5	4	5.2
TC/T/010	45	4400	54	0.75	162	160	132	71	49	34	2600	00.012	0.2	2.5	4	6.4
TC/S/011	48	4300	64	00.9	192	164	133	75	51	31	3200	00.016	2.5	2.5	4	7.7
TC/R/012	45	4200	84	1.18	282	176	147	71	53	41	4000	00.017	2.5	2.5	4	7.4
TC/Q/013	51	3750	132	1.85	396	188	145	80	53	39	4300	00.027	2.5	2.5	4	10
TC/P/014	62	3200	200	02.8	600	212	155	95	56	43	6200	00.036	2.5	0.3	4	12
TC/O/015	76	2750	265	03.7	795	240	173	118	62	49	8900	00.084	2.5	0.3	4	19
TC/N/016	90	2700	355	00.5	1065	270	181	140	68	45	9900	00.148	0.3	3.5	4	27
TC/M/017	95	2600	565	07.9	1695	280	215	145	76	63	13400	00.189	0.3	3.5	4	32
TC/L/018	100	2550	720	10.1	2160	310	195	154	90	15	14200	00.305	3.5	0.4	4	42
TC/K/019	105	2500	940	13.2	2820	316	202	159	96	10	35000	00.358	3.5	0.4	4	48
TC/J/020	130	2200	1440	20.2	4320	370	225	203	110	6	47600	00.815	0.4	4.5	4	79
TC/I/021	130	2000	1795	25.2	5365	370	240	203	115	10	66000	00.868	0.4	4.5	4	85
TC/H/022	150	1700	2870	40.3	8610	412	256	237	118	20	110000	001.49	0.4	0.5	4	115
TC/G/023	150	1600	4445	62.4	13335	448	280	230	125	30	188000	0001.9	4.5	0.6	4	127
TC/F/024	200	1300	6425	90.2	19275	530	282	315	128	26	200000	0004.8	0.5	0.6	4	218
TC/E/025	165	1250	8215	115.3	24645	546	365	280	147	71	310000	0005.2	0.5	0.6	4	224
TC/D/026 and larger																

Standard Design- Hubs of close grain cast iron , Flexible member for operation upto 60 deg C  
 Optrional at extra cost – Hubs of steel , Flexible member with oil & heat resistant properties , higher or lower stiffness , higher ratings

