

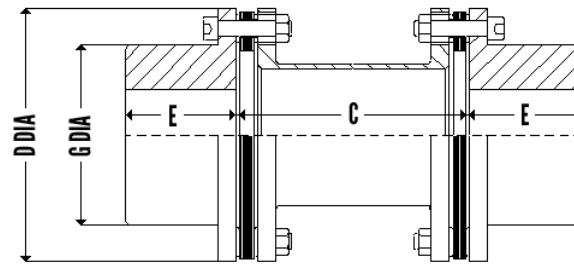

UNIQUE METAFLEX COUPLINGS
Series 80 LQ Coupling

80LQ are simple variations of series 80Q. Series 80LQ is suitable for applications where shaft dia are considerably smaller than the capacity of series 80Q.

GENERAL ASSEMBLY DRAWING



DIMENSIONS AND STANDARD SIZES

Size	Nominal HP/100 RPM	Rating Torque NM	Peak Torque NM	Max Speed RPM	Max Bore MM	E-Hub Length MM	D Dia MM	G Dia MM	STD C MM
300	84	5985	11970	11000	90	86	198	128	140
312	84	5985	11970	11000	100	86	198	140	140
350	95	6770	13540	10500	110	95	221	150	140
375	150	10685	21370	10000	120	102	246	170	180
425	210	14960	29920	8000	125	108	267	178	180
450	260	18500	37000	7000	140	114	287	197	200
500	400	28500	57000	6000	155	127	327	220	225
550	600	42750	85500	5360	175	148	367	250	250
600	800	57000	114000	4850	195	190	406	276	250
700	1200	85500	171000	4250	220	220	464	318	275
750	1600	114000	228000	3920	220	220	510	321	275
800	2120	151000	302000	3570	250	250	560	360	300
850	2735	195000	390000	3330	280	280	600	380	350
900	3350	240000	480000	3075	300	300	650	420	350



**UNIQUE METAFLEX COUPLINGS****Series 80 LQ Coupling****ENGINEERING DATA**

Size	Mass	Inertia	Maximum Misalignment		Torsional Stiffness	Axial Spring Rate	Bolt Torque
	KG	KG.M ²	Axial MM	Radial MM	MNM/Rad	N/MM	# NM
300	23	0.10	3.0	1.2	1.48	370	200
312	22	0.11	1.9	1.2	1.86	415	80
350	32	0.19	2.0	1.2	2.68	500	200
375	43	0.31	2.3	1.5	3.37	540	200
425	57	0.50	2.5	1.5	6.00	725	400
450	68	0.69	2.8	1.7	7.00	755	400
500	100	1.24	3.0	1.9	11.20	920	400
550	130	2.20	3.2	2.1	17.20	920	540
600	ON REQ	ON REQ	3.7	2.1	20.00	1230	700
700	ON REQ	ON REQ	4.1	2.4	40.00	1480	1600
750	ON REQ	ON REQ	4.6	2.4	ON REQ	ON REQ	2160
800	ON REQ	ON REQ	10.0	2.5	ON REQ	ON REQ	2800
850	ON REQ	ON REQ	10.0	3.0	ON REQ	ON REQ	4000
900	ON REQ	ON REQ	10.0	3.0	ON REQ	ON REQ	6000

Mass and inertia, stiffness are at max bore with standard spacer. Dimension C listed above other C Dimensions.

Are available as required on request.hub dimensions can be modified to suit special needs. Max angular.

Misalignment 0.50 deg/pack.misalignment limits are for speeds upto 3000 rpm for higher speeds consult us.

Bolt tightening torques - # for disc pack bolts, ## for hub bolts.

Mass , Inertia, Stiffness are at max bore with standard spacer dimension C listed above. Other C Dimension are available as required on request . Hub dimensions can be modified to suit special needs. Max angular misalignment 0.50 Deg /Pack .Misalignment limits are for speeds upto 3000 RPM. For higher Speeds consult us. Bolt Tightening Torques - # for Disc Pack Bolts, ## for Hub Bolts.