



**UNIQUE METAFLEX COUPLINGS
DBZ-C SPL**

Type DBZ-C couplings are spacer Type Couplings. The spool type spacer can be taken out to remove Pump seals and servicing without having to shift either of connected machines. The couplings are available with standard spacer lengths & can also be supplied with special spacer length.

GENERAL ASSEMBLY DRAWING

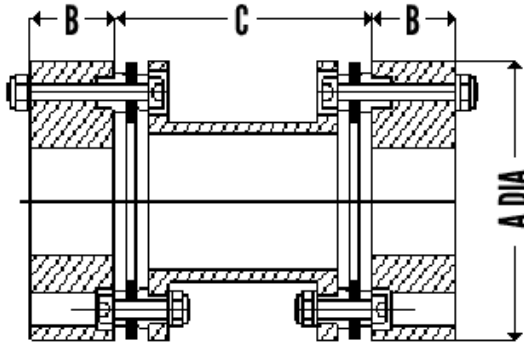

FIG 1. DBZC 62 SPL

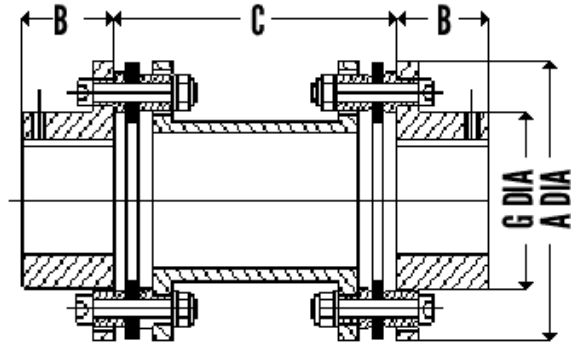

FIG 2. DBZ-C 126 SPL, DBZ-C 201 SPL

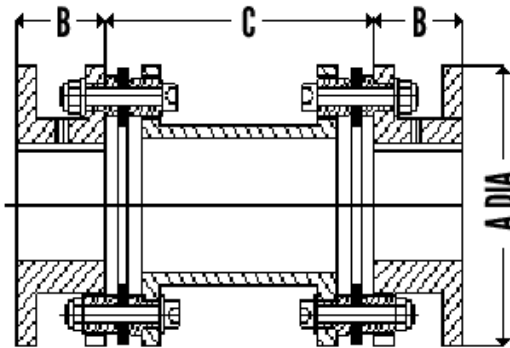

FIG 3. DBZ-C 163 SPL

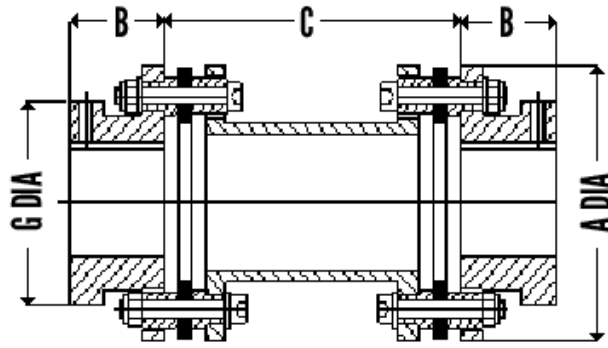

FIG 4. DBZ-C 226 SPL

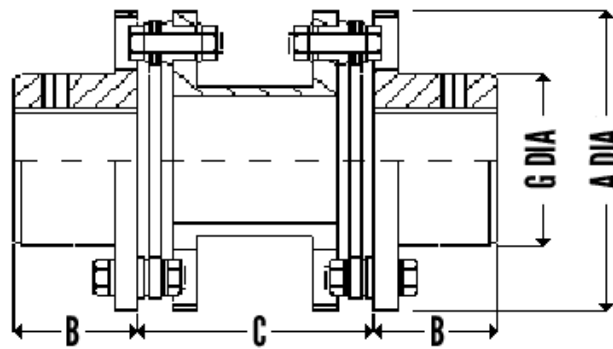

FIG 5. DBZ-C 263SPL & LARGER





DIMENSIONS AND STANDARD SIZES

| Size | Rating HP/100 RPM | Max Bore MM | Max Speed NM | A Dia RPM | B MM | G MM | Fig | Standard Spacers-C MM |
|--------|-------------------------|-------------------|--------------------|--------------|---------|---------|-----|-----------------------------|
| 62SPL | 0.42 | 28 | 9000 | 62 | 22 | - | 1 | 100,140,18 |
| 126SPL | 2.40 | 42 | 6500 | 98 | 28 | 60 | 2 | 100,140,18 |
| 163SPL | 3.50 | 55 | 6000 | 117 | 36 | - | 3 | 100,140,18 |
| 201SPL | 5.30 | 65 | 5500 | 138 | 54 | 90 | 2 | 140,180,25 |
| 226SPL | 11.00 | 75 | 5200 | 156 | 58 | 114 | 4 | 140,180,25 |
| 263SPL | 15.00 | 75 | 4800 | 181 | 76 | 113 | 5 | 140,180,25 |
| 301SPL | 22.30 | 90 | 4500 | 208 | 82 | 129 | 5 | 180,250,30 |
| 351SPL | 44.90 | 100 | 4100 | 241 | 82 | 148 | 5 | 180,250,30 |
| 401SPL | 57.00 | 112 | 3900 | 279 | 105 | 168 | 5 | 180,250,30 |
| 451SPL | 75.00 | 125 | 3600 | 321 | 133 | 187 | 5 | 180,250,30 |

ENGINEERING DATA

| Size | Weight KG | Inertia MR ² KG.CM ² | Weight Change MM | Inertia Change MM | End Float +MM | Bolt Tight Torque NM |
|--------|--------------|---|------------------------|-------------------------|------------------|----------------------------|
| 62SPL | 1.5 | 7.9 | 0.016 | 0.03 | 0.70 | 4 |
| 126SPL | 3.0 | 36.0 | 0.080 | 0.41 | 1.16 | 18 |
| 163SPL | 5.0 | 97.0 | 0.080 | 0.81 | 1.45 | 18 |
| 201SPL | 9.6 | 215.0 | 0.120 | 1.84 | 1.70 | 34 |
| 226SPL | 12.3 | 359.0 | 0.140 | 2.76 | 1.95 | 58 |
| 263SPL | 16.8 | 660.0 | 0.170 | 4.72 | 2.25 | 85 |
| 301SPL | 24.4 | 1320.0 | 0.220 | 7.94 | 2.60 | 130 |
| 351SPL | 40.5 | 2970.0 | 0.320 | 14.95 | 3.00 | 240 |
| 401SPL | 63.5 | 5800.0 | 0.480 | 29.90 | 3.50 | 270 |
| 451SPL | 90.7 | 10250.0 | 0.550 | 41.40 | 3.90 | 350 |

Multiply MR² Values by 4 to obtain GD² values. Weight & Inertia are at max bore with smallest standard spacer. For other spacers use weight & inertia change values to calculate actual figures. Maximum permissible angular misalignment is 1.0 deg for 1500 RPM and 0.5 deg for 3000 RPM at each disc Pack. Standard Construction has hubs , spacers of class2 forged steel IS2004 and Disc Packs of Stainless steel. For plated bolts reduce Tightening Torques by 20 % . Spacer Dimensions other than standard spacers can also be supplied.

All Dimensions are in "mm" unless specified.

The dimensions are for standard execution and subject to change without notice.

