

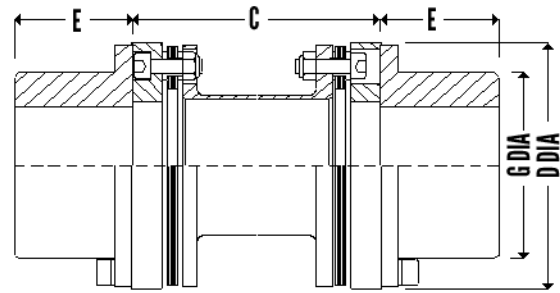

**UNIQUE METAFLEX COUPLINGS**  
**Series 80Q Coupling**

This is a high Torque design. Overall Coupling size is most compact in this design. Weight and Inertia are minimum.



Size	Nominal HP/100 RPM	Rating Torque NM	Peak Torque NM	Max Speed RPM	Max Bore MM	E,Hub Length MM	D Dia MM	G Dia MM	Std C MM
250	37	2635	5270	16500	90	76	173	130	140
262	50	3560	7120	16500	90	76	173	130	140
300	84	5985	11970	11000	110	86	203	157	180
312	84	5985	11970	11000	110	86	203	157	180
350	95	6770	13540	10500	115	95	227	162	180
375	150	10685	21370	10000	130	102	252	187	200
425	210	14960	29920	8000	140	120	273	200	200
450	280	20000	40000	7000	160	130	293	230	250
500	400	28500	57000	6000	180	140	333	260	250
550	600	42750	85500	5360	210	160	373	As Reqd.	300
600	800	57000	114000	4850	220	As Reqd.	412	Do	300
700	1200	85500	171000	4250	270	As Reqd.	470	Do	325
750	1600	114000	228000	3920	300	As Reqd.	510	Do	325
800	2120	151000	302000	3570	330	As Reqd.	560	Do	350
850	2735	195000	390000	3330	370	As Reqd.	600	Do	550
900	3350	240000	480000	3075	400	As Reqd.	650	Do	550





**UNIQUE METAFLEX COUPLINGS**  
**Series 80Q Coupling**

Size	Mass	Inertia	Maximum Misalignment		Torsional Stiff	Axial Spring	Bolt Torque	
	KG	KG.M <sup>2</sup>	AXIAL MM	RADIAL MM	MNM/RAD	Rate N/MM	# NM	## MM
250	20	0.082	2.2	1.2	0.38	195	80	48
262	20	0.082	1.5	1.2	0.44	350	80	48
300	34	0.190	3.0	1.2	0.64	370	200	80
312	30	0.170	1.9	1.2	0.64	415	80	80
350	42	0.300	2.0	1.2	1.07	500	200	200
375	55	0.470	2.3	1.5	1.38	540	200	200
425	75	0.770	2.5	1.5	2.14	725	400	200
450	97	1.150	2.8	1.7	2.36	755	400	200
500	122	1.950	3.0	1.9	3.92	920	400	400
550	155	3.000	3.2	2.1	5.64	920	540	400
600	On Req.	On Req.	3.7	2.1	6.93	1230	700	400
700	On Req.	On Req.	4.1	2.4	11.30	1480	1600	1400
750	On Req.	On Req.	4.6	2.4	On Req.	On Req.	2160	1600
800	On Req.	On Req.	10.0	2.5	On Req.	On Req.	2800	1600
850	On Req.	On Req.	10.0	3.0	On Req.	On Req.	4000	1600
900	On Req.	On Req.	10.0	3.0	On Req.	On Req.	6000	2160

Mass and inertia, stiffness is at max bore with standard spacer. Dimension C listed above. Other c dimensions are available as required on request. Hub dimensions can be modified to suit special needs. Max angular Misalignment 0.50 deg/pack. Misalignment limits are for speeds upto 3000 rpm. For higher speeds consult us. Bolt tightening torques - # for disc pack bolts , ## for hub bolts.

*All Dimensions are in "mm" unless specified.  
 The dimensions are for standard execution and subject to change without notice.*

