



UNIQUE METAFLEX COUPLINGS

Series 80 CMR SPL Coupling

Type CMR Couplings are similar to the Type AMR except that one hub is substituted by a flange adaptor plate. This makes the coupling specially suitable for direct attachment to the Flywheel of engines, reciprocating compressors etc without an extension shaft.

GENERAL ASSEMBLY DRAWING

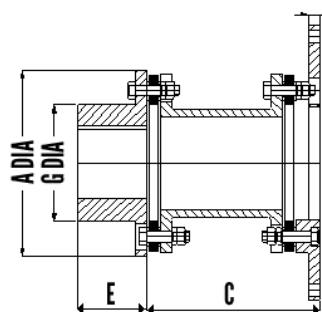

Adaptor Type	OD Inch	Bolting Light Duty SAE		Bolting Unique Heavy Duty			
		PCD Inch	No of Holes	Size Inch	PCD Inch	No. of Holes	Size Inch
A	8.500/8.498	7.875	6	11/32	7.500	8	13/32
B	9.500/9.498	8.750	8	11/32	8.625	8	15/32
C	10.375/10.37	9.625	6	13/32	9.500	8	15/32
D	12.375/12.37	11.625	8	13/32	11.500	8	17/32
E	13.875/13.87	13.125	8	13/32	12.500	8	21/32
F	16.000/15.99	-	-	-	14.375	8	25/32
G	18.375/18.37	17.250	8	17/32	16.750	8	25/32
H	20.375/20.37	19.250	8	17/32	18.500	8	29/32
I	22.500/22.49	21.375	6	21/32	20.500	8	1-1/32"
J	26.500/26.49	25.250	12	21/32	24.500	12	1-1/32"
K	28.875/28.87	27.250	12	25/32	26.875	12	1-1/32"

DIMENSIONS AND STANDARD SIZES

Size	Nominal HP/100 RPM	Rating Torque NM	Peak Torque Rating NM	Max Speed RPM	Max Bore MM	A MM	E MM	C MM	G MM	T MM
162	7.0	500	1000	3000	48	117	44	85	70	8
200	13.5	960	1710	3000	60	146	54	100	84	10
225	19.0	1356	2564	3000	65	153	64	100	95	10
262	33.0	2350	4700	3000	80	175	73	115	114	11
312	56.0	3990	7980	3000	95	206	86	135	138	13
350	76.2	5425	10850	2750	100	232	95	150	152	13
375	100.0	7125	14250	2500	115	256	102	170	165	14
425	140.0	9975	19950	2200	125	279	108	180	177	18
450	170.0	12110	24220	1900	135	302	114	195	189	16
500	270.0	19230	38460	1800	150	341	127	222	213	19
550	400.0	28500	57000	1800	170	381	140	250	240	22
600	500.0	35625	71250	1800	185	425	153	276	262	25
Q600	800.0	57000	114000	1800	185	425	178	276	262	25
700	800.0	57000	114000	1500	210	481	178	316	298	25
Q700	1200.0	85500	171000	1500	210	481	184	316	298	25
750	1100.0	78375	156750	1500	225	524	184	343	321	29
Q750	1600.0	114000	228000	1500	225	524	197	343	321	29
800	1600.0	114000	228000	1200	245	568	197	375	349	32
Q800	2120.0	151000	302000	1200	245	568	197	375	380	32





UNIQUE METAFLEX COUPLINGS

Series 80 CMR SPL Coupling

ENGINEERING DATA

Size	Mass KG	Inertia KG.M ²	Maximum Misalignment		Torsional Stiffness MNM/Rad	F. Wheel STD Adaptars MM	Bolt Torque MM
			Axial MM	Radial RPM			
162	4	0.01	1.30	0.58	0.30	A,B,C,D	24
200	6	0.02	1.80	0.66	0.51	A,B,C,D,E	48
225	8	0.04	1.40	0.66	0.97	A,B,C,D,E	48
262	14	0.06	1.50	0.77	1.49	A,B,C,D,E,F,G	48
312	20	0.12	1.90	0.92	2.69	B,C,D,E,F,G,H	80
350	28	0.20	2.00	1.01	4.00	D,E,F,G,H,I	200
375	38	0.33	2.30	1.13	4.91	D,E,F,G,H,I	200
425	50	0.57	2.50	1.23	7.10	E,F,G,H,I	400
450	63	0.80	2.80	1.32	8.30	F,G,H,I,J	400
500	90	1.53	3.00	1.51	12.50	F,G,H,I,J,K	400
550	122	2.48	3.20	1.70	18.60	G,H,I,J,K	540
600	160	3.96	3.70	1.88	19.30	H,I,J,K	700
Q600	160	3.96	3.70	1.88	22.00	H,I,J,K	700
700	250	7.63	4.10	2.14	31.60	H,I,J,K	1400
Q700	250	7.63	4.10	2.14	35.00	H,I,J,K	1400
750	304	10.60	4.60	2.33	39.00	J,K	1400
Q750	304	10.60	4.60	2.33	42.00	J,K	1400
800	400	18.10	5.00	2.52	58.00	J,K	1400
Q800	400	18.10	5.00	2.52	60.00	J,K	2200

Max Bore capacity with rectangular Key. Mass and Inertia are at Max Bore with minimum Adapter Diameter. Maximum Speed corresponds to smallest standard adapter. Hubs , Spacer , Adapter Plate of Forged Steel ASTM A668 Gr F . Disc Packs of Stainless Steel Bolts Gr 10.9 ASTM A490M, Lock Nuts ASTM A194 Gr 2H. Each Hub with 2 No Puller Holes. Hubs , Spacer Dynamically Balanced to 6350 W/N gm.mm , Assembly Check Balanced to 63500 W/N gm.mm

