

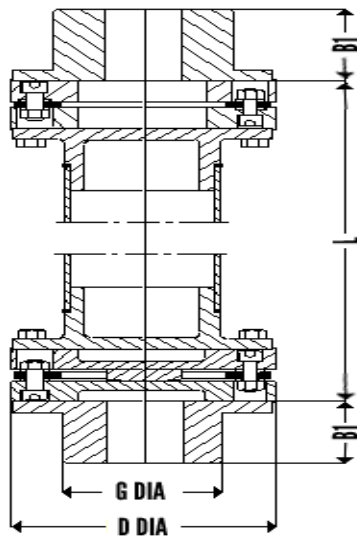

Metaflex Vertical Floating Shaft Series

**Series 80 SV & Type SF**

**GENERAL ASSEMBLY DRAWING**



**SERIES 80 SV**

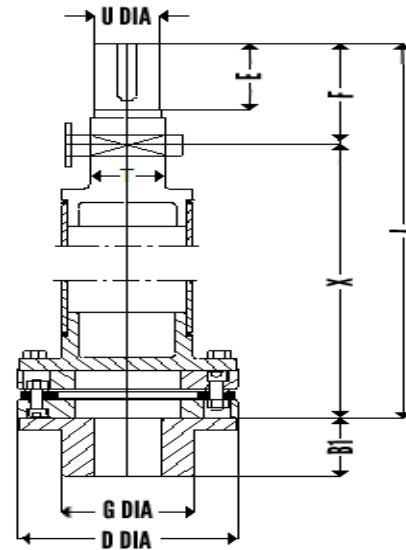

**TYPE SF**

**DIMENSIONS AND STANDARD SIZES**

Size	Nominal HP/100 RPM	Nominal Torque Nm	Peak Torque Nm	Max Bore mm	D	G	B1
65	0.45	32	64	28	66	42	28
80	0.9	64	128	38	75	54	30
100	1.8	128	256	42	87	60	32
125	2.6	185	370	48	102	70	41
150	4.0	285	570	48	105	69	45
162	7.0	500	1000	55	115	80	48
180	9.0	640	1280	65	130	90	55
200	12.0	855	1710	70	143	100	54
220	15.0	1070	2140	80	143	112	62
225	18.0	1282	2562	75	148	110	67
250	25.0	1780	3560	80	173	130	76
262	33.0	2350	4700	90	173	130	76
300	56.0	3990	7980	110	203	157	86
312	56.0	3990	7980	110	203	157	86
350	70.0	4990	9980	115	227	162	95
375	100.0	7125	14250	130	252	187	102
425	140.0	9975	19950	130	273	191	108
450	170.0	12110	24220	145	293	211	114
500	270.0	19230	38460	175	333	251	127
550	400.0	28500	57000	190	373	270	148
600	500.0	35625	71250	210	412	as reqd	153
700	800.0	57000	114000	240	470	as reqd	178
750	1100.0	78375	156750	270	510	as reqd	191
800	1600.0	114000	228000	300	553	as reqd	210





## Metaflex Vertical Floating Shaft Series

**80SV-SF**

Size	Weight		Inertia MR <sup>2</sup>		End Float		Bolt Torque # Nm	Bolt Torque ## Nm
	SV	SF	SV	SF	SV(+)	SF(*)SV(-)		
	Kg	Kg	Kg.m <sup>2</sup>	Kg.m <sup>2</sup>	mm	mm		
65	1.9	2.0	0.001	0.001	1.00	0.50	6	6
80	2.7	2.3	0.002	0.002	1.20	0.60	10	6
100	4.1	2.7	0.004	0.003	2.00	1.00	24	10
125	6.0	4.3	0.009	0.005	2.00	1.00	24	24
150	6.1	4.4	0.009	0.005	1.30	0.65	24	24
162	8.1	6.6	0.014	0.008	1.30	0.65	24	48
180	11.0	9.5	0.027	0.016	1.50	0.75	48	48
200	14.0	11.2	0.040	0.024	1.80	0.90	48	48
220	16.8	15.1	0.043	0.026	2.00	1.00	48	48
225	17.5	13.5	0.044	0.027	1.40	0.70	48	48
250	24.4	21.2	0.105	0.064	2.20	1.10	48	48
262	24.2	21.1	0.105	0.064	1.50	0.75	48	48
300	43.2	35.7	0.250	0.152	3.00	1.50	200	80
312	36.8	30.4	0.220	0.134	1.90	0.95	80	80
350	53.0	40.5	0.400	0.244	2.00	1.00	200	200
375	68.0	55.6	0.600	0.366	2.30	1.15	200	200
425	94.0	74.0	1.000	0.610	2.50	1.25	400	400
450	121.0	on req	1.480	on req	2.80	1.40	400	400
500	150.0	on req	2.490	on req	3.00	1.50	400	400
550	187.0	on req	3.800	on req	3.20	1.60	540	540
600	255.0	on req	6.700	on req	3.70	1.85	700	700
700	388.0	on req	12.800	on req	4.10	2.05	1400	1400
750	480.0	on req	17.700	on req	4.60	2.30	1800	1400
800	680.0	on req	30.000	on req	5.00	2.50	2400	1400

**Note - Mass and Inertia are excluding tube and at max bore. Max misalignment 0.5 deg/pack For Maximum Length , Permissible speeds and Tube Dia - see Selection Table. '(+)' indicates only axial extension , (-) indicates axial compression , (\*) indicates expansion as well as compression.**